

PRH6D28



FEATURES 特点

- * Excellent solderability and high heat resistance
良好的可焊性和高耐热性

APPLICATION 用途

- * DC / DC 转换器

MEASURING FREQUENCY 测试频率

- * 100KHz 0.3V

Shapes And Dimensions 外形及尺寸示意图

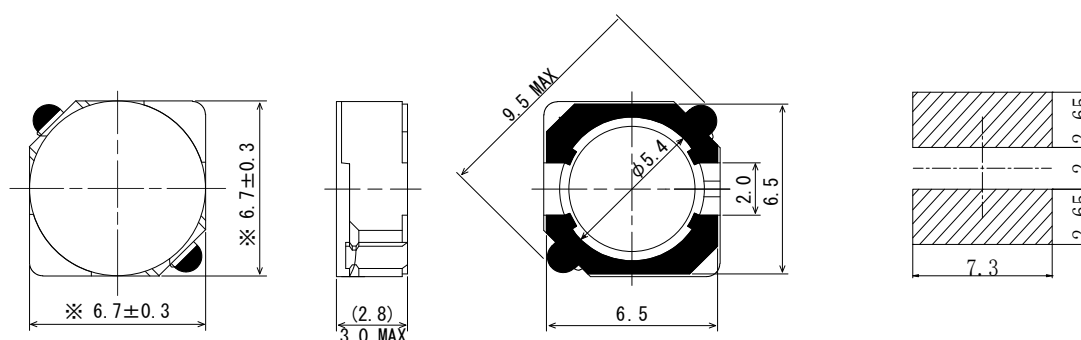

Electrical Characteristics 电气性能

Type 型号	Indicate 表示	Inductance 电感值	D.C.R(Max) 直流电阻 (m Ω)	Rated Current(Max) 额定电流 (A)
PRH6D2 8-3R0	3R0	3.0 μ H \pm 30%	24(18)	3.00
PRH6D2 8-3R9	3R9	3.9 μ H \pm 30%	27(20)	2.60
PRH6D2 8-5R0	5R0	5.0 μ H \pm 30%	31(23)	2.40
PRH6D2 8-6R0	6R0	6.0 μ H \pm 30%	35(26)	2.25
PRH6D2 8-7R3	7R3	7.3 μ H \pm 30%	54(40)	2.10
PRH6D2 8-8R6	8R6	8.6 μ H \pm 30%	58(43)	1.85
PRH6D2 8-100	100	10 μ H \pm 30%	65(48)	1.70
PRH6D2 8-120	120	12 μ H \pm 30%	70(52)	1.55
PRH6D2 8-150	150	15 μ H \pm 30%	84(62)	1.40
PRH6D2 8-180	180	18 μ H \pm 30%	95(70)	1.32
PRH6D2 8-220	220	22 μ H \pm 30%	128(95)	1.20
PRH6D2 8-270	270	27 μ H \pm 30%	142(105)	1.05
PRH6D2 8-330	330	33 μ H \pm 30%	165(122)	0.97
PRH6D2 8-390	390	39 μ H \pm 30%	210(156)	0.86
PRH6D2 8-470	470	47 μ H \pm 30%	238(176)	0.80
PRH6D2 8-560	560	56 μ H \pm 30%	277(205)	0.73
PRH6D2 8-680	680	68 μ H \pm 30%	304(225)	0.65
PRH6D2 8-820	820	82 μ H \pm 30%	390(290)	0.60
PRH6D2 8-101	101	100 μ H \pm 30%	535(397)	0.54

* SPQ:2000PCS/REEL

The sample parameters are based on actual measured values